

CONDUCTOR SPECIFICATIONS:

COMPONENT I
 CONDUCTOR: 30 AWG SINGLES 7/38 TIN PLATED COPPER, 0.31 [.012] DIAMETER
 INSULATION: 0.15 [.006] OF POLYPROPYLENE, 0.61 [.024] DIAMETER
 COMPONENT II
 CONDUCTOR: 26 AWG SINGLES 7/38 TIN PLATED COPPER, 0.48 [.019] DIAMETER
 INSULATION: 0.15 [.006] OF POLYPROPYLENE, 0.79 [.031] DIAMETER
 COMPONENT III
 CONDUCTOR: 30 AWG SHIELDED PAIRS 7/38 TIN PLATED COPPER, 0.31 [.012] DIAMETER
 INSULATION: 0.15 [.006] INCHES OF POLYPROPYLENE, 0.61 [.024] DIAMETER
 COMPONENT IV
 CONDUCTOR: 30 AWG UNSHIELDED PAIRS 7/38 TIN PLATED COPPER, 0.31 [.012] DIAMETER
 INSULATION: 0.15 [.006] INCHES OF POLYPROPYLENE, 0.61 [.024] DIAMETER
 BEND RADIUS: 12X CABLE DIAMETER (SEE EXAMPLE) PER SPECIFICATIONS
 2014 NEC SECTION 300.34 CONDUCTOR BEND RADIUS
 2014 NEC SECTION 300.24 BENDING RADIUS

1. REFER TO PRODUCT MANUAL ON NI.COM FOR MORE DETAILS.
 NOTES: UNLESS OTHERWISE SPECIFIED.

TABLE 1	
LENGTH	TOLERANCE
<2M	+5 CM/-0 CM
2 TO 5M	+10 CM/-0 CM
>5M	+15 CM/-0 CM

METRIC

CUSTOMER DRAWING

UNLESS OTHERWISE SPECIFIED
 DIMENSIONS ARE IN INCHES AND
 [MILLIMETERS]
 DO NOT SCALE DRAWING
 THIRD ANGLE PROJECTION

NI.COM
 AUSTIN, TEXAS
 TITLE
 SHC68-68M-EPM

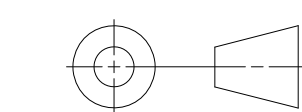

SIZE CODE IDENT NO. MM/DD/YYYY
 D 7U296 04/12/2022
 SCALE: 1/1 SHEET 1 OF 1

WIRE LIST						
ANALOG BUNDLE – 8 SHIELDED PAIRS, 2 PAIRS, 2 SINGLES, OUTER SHIELD				P1 .050	P2 VHDCI	SIGNAL NAME
BUNDLE	PAIR NO	SINGLE NO	COLOR CODE	PIN NO	PIN NO	STC II
A	1		WHITE/BLACK	65	65	AI 2
			BLACK/WHITE	31	31	AI 10
	SHIELD 1			64	64	AI GND
	2		WHITE/BROWN	63	63	AI 11
			BROWN/WHITE	30	30	AI 3
	SHIELD 2			29	29	AI GND
	3		WHITE/RED	57	57	AI 7
			RED/WHITE	23	23	AI 15
	SHIELD 3			56	56	AI GND
	4		WHITE/ORANGE	68	68	AI 0
			ORANGE/WHITE	34	34	AI 8
	SHIELD 4			67	67	AI GND
	5		WHITE/GREEN	66	66	AI 9
			GREEN/WHITE	33	33	AI 1
	SHIELD 5			32	32	AI GND
	6		WHITE/BLUE	58	58	AI 14
			BLUE/WHITE	25	25	AI 6
	SHIELD 6			24	24	AI GND
	7		WHITE/VIOLET	60	60	AI 5
			VIOLET/WHITE	26	26	AI 13
	SHIELD 7			59	59	AI GND
	8		WHITE/GRAY	61	61	AI 12
			GRAY/WHITE	28	28	AI 4
	SHIELD 8			27	27	AI GND
	9		BROWN/BLACK	22	22	AO 0
			BLACK/BROWN	54	54	AO GND 0
	10		RED/BLACK	21	21	AO 1
			BLACK/RED	55	55	AO GND 1
	1	1	WHITE/YELLOW	62	62	AI SENSE 1
		2	RED/BLUE	20	20	APFI 0
	CORE SHIELD			54	54	AO GND 0

WIRE LIST (CONT.)						
DIGITAL BUNDLE – 12 PAIRS (B), 12 TWISTED PAIRS/2 SINGLES (C)				P1 .050	P2 VHDCI	SIGNAL NAME
BUNDLE	PAIR NO	COLOR CODE	PIN NO	PIN NO	STC II	
B	1	BLACK/VIOLET	53	53	D_GND	
		VIOLET/BLACK	19	19	P0.4	
	2	BLACK/BLUE	52	52	P0.0	
		BLUE/BLACK	18	18	D_GND	
	3	BLUE/GREEN	51	51	P0.5	
		GREEN/BLUE	18	18	D_GND	
	4	BLACK/GREEN	50	50	D_GND	
		GREEN/BLACK	17	17	P0.1	
	5	VIOLET/ORANGE	50	50	D_GND	
		ORANGE/VIOLET	16	16	P0.6	
	6	BLACK/YELLOW	49	49	P0.2	
		YELLOW/BLACK	15	15	D_GND	
	7	GRAY/RED	48	48	P0.7	
		RED/GRAY	15	15	D_GND	
	8	YELLOW/ORANGE	47	47	P0.3	
		ORANGE/YELLOW	13	13	D_GND	
	9	BLACK/ORANGE	46	46	PFI 11/P2.3	
		ORANGE/BLACK	13	13	D_GND	
	10	BROWN/GRAY	45	45	PFI 10/P2.2	
		GRAY/BROWN	12	12	D_GND	
	11	RED/ORANGE	44	44	D_GND	
		ORANGE/RED	11	11	PFI 0/P1.0	
	12	PINK/BLACK	44	44	D_GND	
		BLACK/PINK	10	10	PFI 1/P1.1	
C	1	BROWN/VIOLET	43	43	PFI 2/P1.2	
		VIOLET/BROWN	9	9	D_GND	
	2	BROWN/BLUE	42	42	PFI 3/P1.3	
		BLUE/BROWN	9	9	D_GND	
	3	RED/YELLOW	41	41	PFI 4/P1.4	
		YELLOW/RED	7	7	D_GND	
	4	YELLOW/GREEN	40	40	PFI 13/P2.5	
		GREEN/YELLOW	7	7	D_GND	
	5	BROWN/GREEN	35	35	D_GND	
		GREEN/BROWN	6	6	PFI 5/P1.5	
	6	BROWN/YELLOW	39	39	PFI 15/P2.7	
		YELLOW/BROWN	7	7	D_GND	
	7	ORANGE/GREEN	4	4	D_GND	
		GREEN/ORANGE	5	5	PFI 6/P1.6	
	8	BROWN/ORANGE	38	38	PFI 7/P1.7	
		ORANGE/BROWN	4	4	D_GND	
	9	YELLOW/BLUE	37	37	PFI 8/P2.0	
		BLUE/YELLOW	4	4	D_GND	
	10	ORANGE/BLUE	36	36	D_GND	
		BLUE/ORANGE	3	3	PFI 9/P2.1	
	11	BROWN/RED	36	36	D_GND	
		RED/BROWN	2	2	PFI 12/P2.4	
	12	BLACK/GRAY	35	35	D_GND	
		GRAY/BLACK	1	1	PFI 14/P2.6	
SINGLE	ORANGE/GRAY	8	8	+5V		
SINGLE	VIOLET/RED	14	14	+5V		
	OUTER SHIELD		SHELL	SHELL	SHIELD	