

CUSTOMER DRAWING

UNLESS OTHERWISE SPECIFIED
DIMENSIONS ARE IN INCHES AND
[MILLIMETERS].

DO NOT SCALE DRAWING

THIRD ANGLE PROJECTION

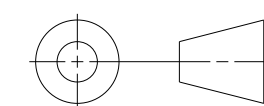

AUSTIN, TEXAS

TITLE

NI 9251
2 CH-MINI XLR

SIZE CODE IDENT NO. MM/DD/YYYY

C7U296

04/01/2016

SCALE:

1/1

SHEET 1 OF 1

CU-NI-9260_MINI_XLR

1. REFER TO PRODUCT MANUAL ON NI.COM FOR MORE DETAILS
NOTES: UNLESS OTHERWISE SPECIFIED.